

# TECHNICAL PRODUCT SUBMITTAL

## LBT10000 THERMAL STORE

### LBT10000

EFFICIENCY DATA-Part L2	
Insulation Thickness	mm
Insulation Type	
Heat Loss	kWh/24h
EFFICIENCY DATA ErP AND ENERGY LABEL	
Ecodesign Energy Label rating	
Standing Loss	W
GENERAL DATA	
Storage Capacity	litres
Weight Empty	kg
Weight Full and Insulated	kg
Maximum Vessel Pressure	bar
Maximum Vessel Temperature	°C

100
Ecozero
n/a
n/a
n/a
10000
973
10973
5
95

The LBT Thermal store must be installed and maintained in line with the Installation Commissioning and Maintenance Instructions which are available on the Literature & Downloads section of [www.lochinvar.ltd.uk](http://www.lochinvar.ltd.uk)

#### ErP and Warranty

ErP Data including Product Fiche and Energy Labels where applicable and Warranty information are also available at [www.lochinvar.ltd.uk](http://www.lochinvar.ltd.uk)

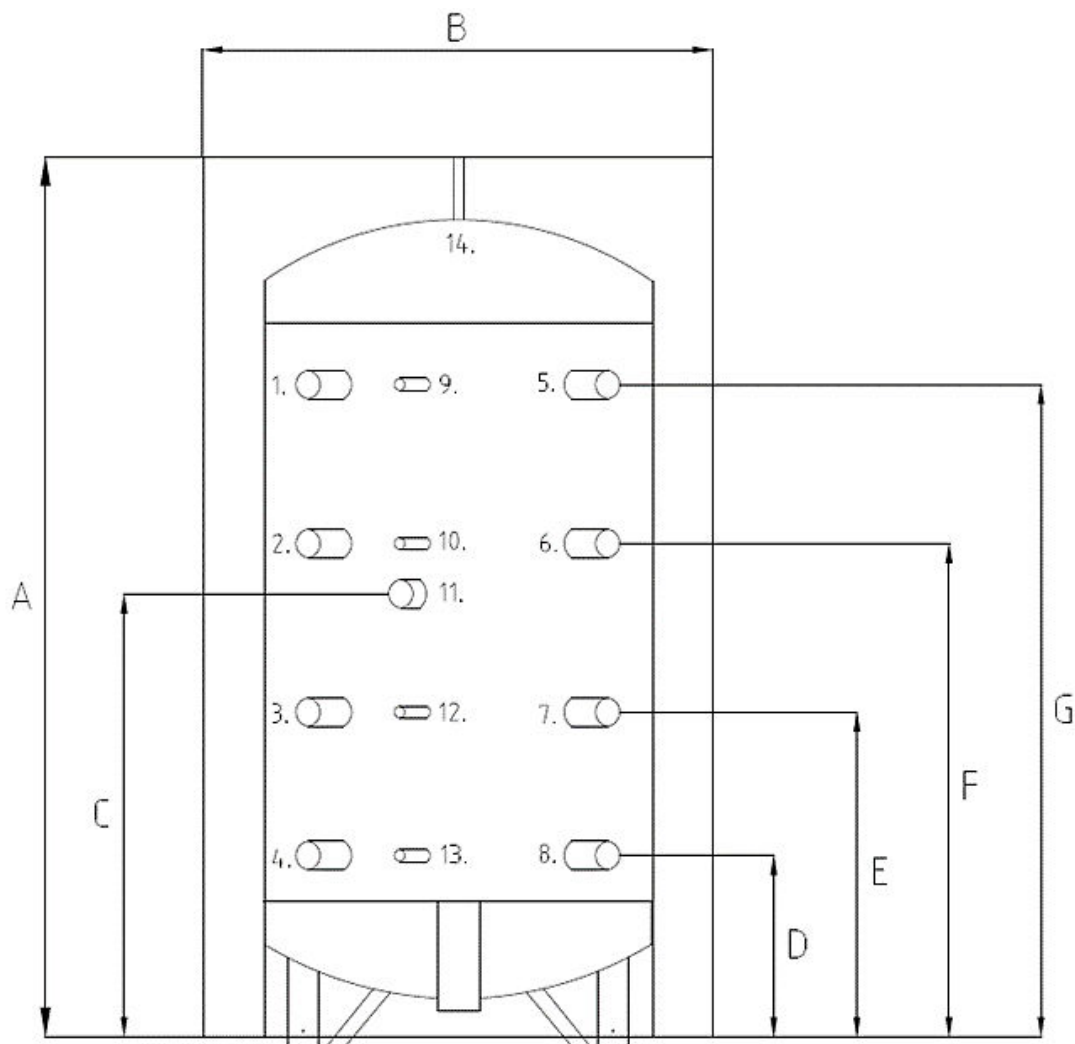

# TECHNICAL PRODUCT SUBMITTAL

## LBT10000 THERMAL STORE



No	Description	Unit	LBT6000	LBT8000	LBT10000
A	Total Height (with insulation)	mm	2790	3490	4240
B	Diameter of Water Heater (with insulation)	mm	2000	2000	2000
C	Height of Immersion heater connection	mm	1415	1615	2365
D	Connection ASHP return	mm	635	625	625
E	Height of Tank body connection	mm	1155	1385	1635
F	Height of Tank body connection	mm	1675	2145	2645
G	Connection ASHP flow	mm	2195	2905	3655
A	Height of AAV Connection	mm	2790	3490	4240

No	Description	Unit	LBT6000	LBT8000	LBT10000
1	Connection Heating System Flow	BSP	3"	3"	3"
2	Connection Tank body	BSP	3"	3"	3"
3	Connection Tank body	BSP	3"	3"	3"
4	Connection Heating System Return	BSP	3"	3"	3"
5	Connection ASHP Flow	BSP	3"	3"	3"
6	Connection Tank body	BSP	3"	3"	3"
7	Connection Tank body	BSP	3"	3"	3"
8	Connection ASHP Return	BSP	3"	3"	3"
9	Connection Sensor Point	BSP	½"	½"	½"
10	Connection Sensor Point	BSP	½"	½"	½"
11	Connection	BSP	1½"	1½"	1½"
12	Connection Sensor Point	BSP	½"	½"	½"
13	Connection Sensor Point	BSP	½"	½"	½"
14	Connection Air Vent	BSP	2"	2"	2"