

## Spares Parts List

### LST66 - 220GE after 18-9-17

Nr.	Description of Item	Item Comments	Refer To Drawing in Page 2					
			LSTS66GE	LST100GE	LST110GE	LST130GE	LST165GE	LST220GE
1	Anode	Anode Magnesium 480mm 1¼"	LV301521			-		
		Anode Magnesium 600mm 1¼"	-			LV301634	-	
		Anode Magnesium 730mm 1¼"	-			LV301637		
	Flexible Anode	Anode Magnesium Flex 1¼"	LV301727					
2	Inspection Door Gasket	Gasket Flange	LV301535			LV301536		
6	Clean out door Cover Front	Cover Front	LV312812			LV312816		
7	Cover Jacket (Cover Jacket with Insulation)	Cover Jacket	LV312778	LV312926	LV312779	LV312927	LV312811	
8	Complete Insulation Package (Insulation Jacket, Insulation Top and Cover Jacket)	Insulation S-300 ALU	LV310653	-				
		Insulation S-400 ALU	-	LV307810	-			
		Insulation S-500 ALU	-	LV307811	-			
		Insulation S-600 ALU	-	LV307812	-			
		Insulation S-750 ALU	-	LV307813	-			
		Insulation S-1000 ALU	-	LV307814	-			
9	Inspection Door	Flange	LV301517			-		
			-			LV301534		

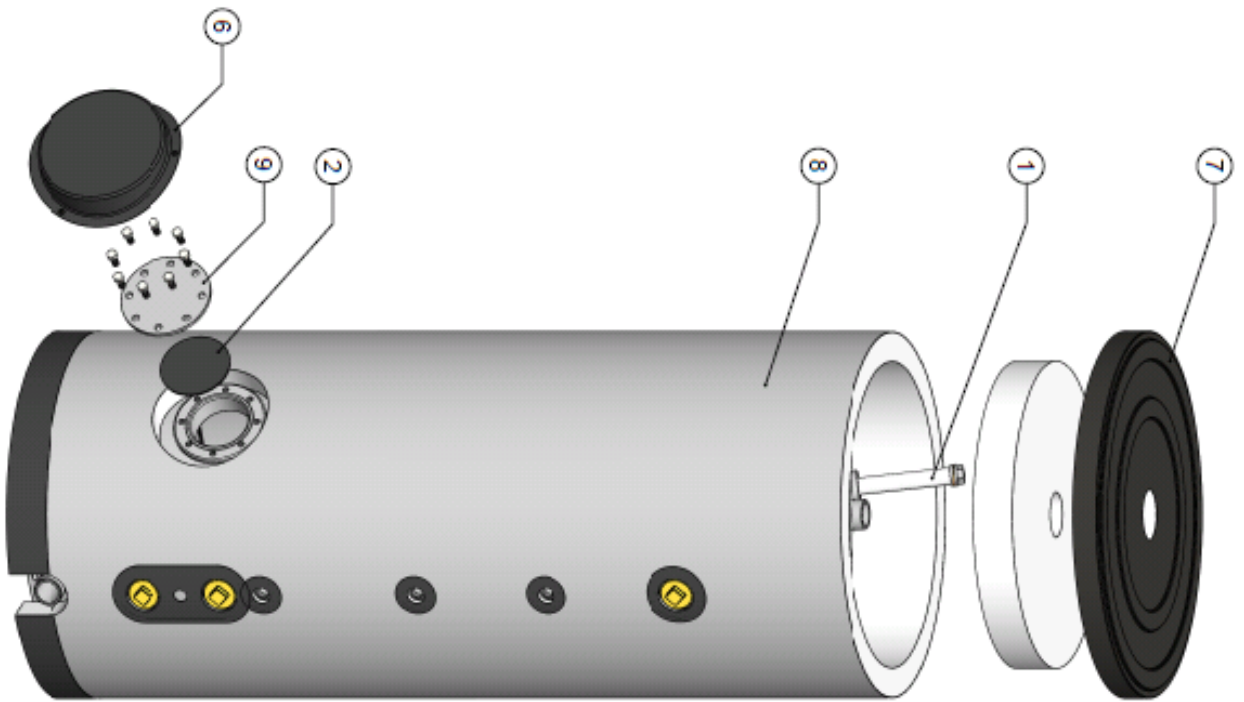

LINEAR TOLERANCES UNLESS NOTED DECIMALS ± 0.1mm / ANGLES ± 2°		REVERSE BY COMPUTER ONLY		AM PROJ.		SCALE					
SIZE TOLERANCE SIZE AND FACE TOLERANCES SEE NEN-ISO 1101		SEE NEN-ISO 401 SEE NEN-ISO 1101								<b>A4</b> size LST 66-220	
										MATERIAL - FINISH SPEC. -	
										PART NUMBER <b>EVD-0075</b>	
REV 0		RELEASE		CHG. NO. 8859		BY MIG		DATE 220114		CH	
		CHANGES									