

TECHNICAL PRODUCT SUBMITTAL

LBT8000 THERMAL STORE



LBT8000

EFFICIENCY DATA-Part L2	
Insulation Thickness	mm
Insulation Type	
Heat Loss	kWh/24h
EFFICIENCY DATA ErP AND ENERGY LABEL	
Ecodesign Energy Label rating	
Standing Loss	W
GENERAL DATA	
Storage Capacity	litres
Weight Empty	kg
Weight Full and Insulated	kg
Maximum Vessel Pressure	bar
Maximum Vessel Temperature	°C

100
Ecozero
n/a
n/a
n/a
8000
823
8823
5
95

The LBT Thermal store must be installed and maintained in line with the Installation Commissioning and Maintenance Instructions which are available on the Literature & Downloads section of www.lochinvar.ltd.uk

ErP and Warranty

ErP Data including Product Fiche and Energy Labels where applicable and Warranty information are also available at www.lochinvar.ltd.uk

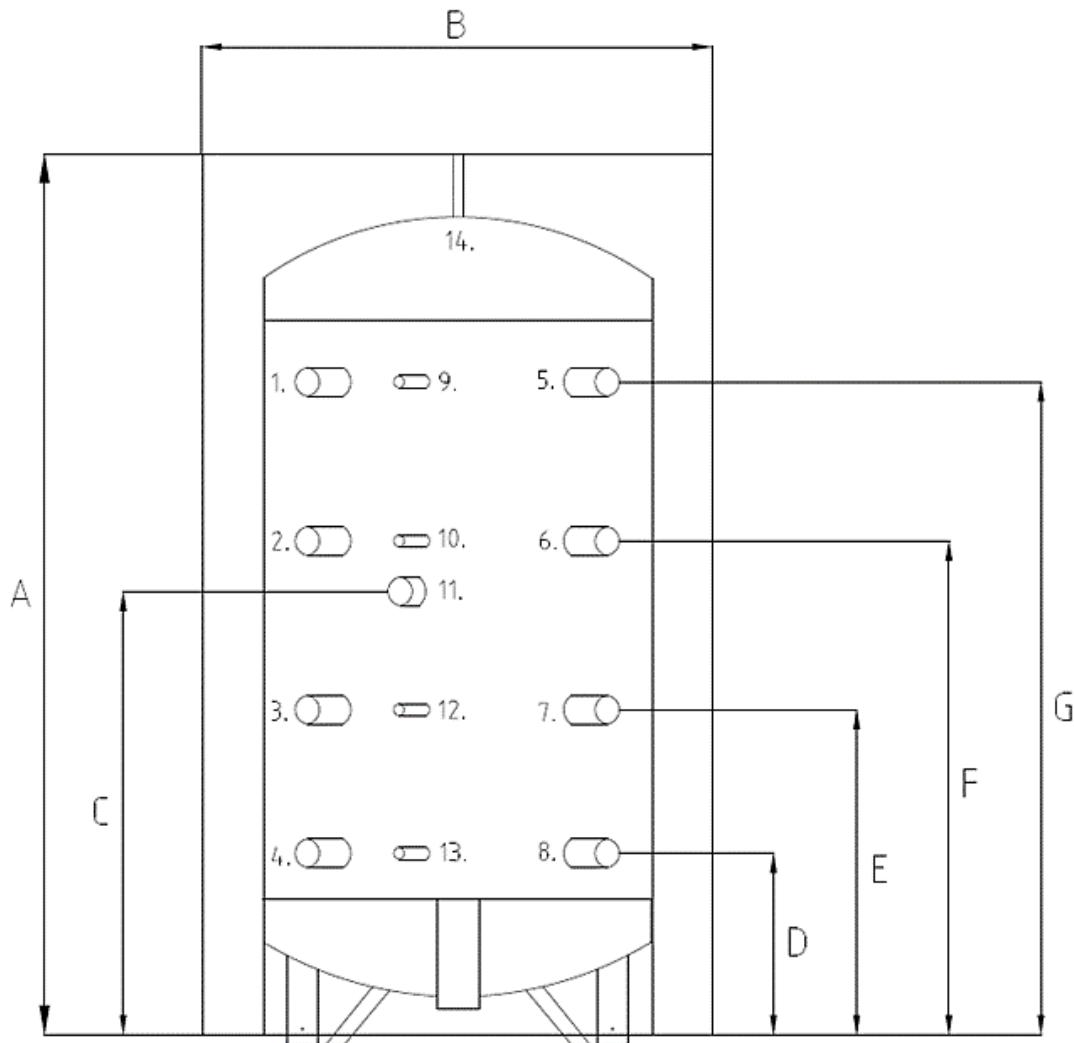

TECHNICAL PRODUCT SUBMITTAL

LBT8000 THERMAL STORE



No	Description	Unit	LBT6000	LBT8000	LBT10000
A	Total Height (with insulation)	mm	2790	3490	4240
B	Diameter of Water Heater (with insulation)	mm	2000	2000	2000
C	Height of Immersion heater connection	mm	1415	1615	2365
D	Connection ASHP return	mm	635	625	625
E	Height of Tank body connection	mm	1155	1385	1635
F	Height of Tank body connection	mm	1675	2145	2645
G	Connection ASHP flow	mm	2195	2905	3655
A	Height of AAV Connection	mm	2790	3490	4240

No	Description	Unit	LBT6000	LBT8000	LBT10000
1	Connection Heating System Flow	BSP	3"	3"	3"
2	Connection Tank body	BSP	2"	2"	2"
3	Connection Tank body	BSP	3"	3"	3"
4	Connection Heating System Return	BSP	3"	3"	3"
5	Connection ASHP Flow	BSP	3"	3"	3"
6	Connection Tank body	BSP	2"	2"	2"
7	Connection Tank body	BSP	2"	2"	2"
8	Connection ASHP Return	BSP	3"	3"	3"
9	Connection Sensor Point	BSP	½"	½"	½"
10	Connection Sensor Point	BSP	½"	½"	½"
11	Connection Immersion heater	BSP	1½"	1½"	1½"
12	Connection Sensor Point	BSP	½"	½"	½"
13	Connection Sensor Point	BSP	½"	½"	½"
14	Connection Air Vent	BSP	1"	1"	1"