

## EFB SHORT REPLACEMENT PARTS LIST



### EFB85-EFB125 version B-any boiler manufactured after week 22-2020

Item No	Description of item	Item Comments	EFB85	EFB105	EFB125
<b>USE IN CONJUNCTION WITH DRAWING 1</b>					
1	Service kit			LE000500001	
2	Set. Electronics holder			LE000500002	
3	Set. Anchoring bar		LE000500007	LE000500008	LE000500009
5	Water pressure sensor 10bar			LE001500004	
7	Flow pipe		LE001500006	LE001500007	LE001500007
8	Return pipe		LE002500003	LE002500004	LE002500004
9	O-ring gas valve connection			LE003100007	
10	Gas pipe			LE003500003	
13	NTC sensor 1/8" SS	Use with LE022000001		LE004100018	
14	NTC Flue gas sensor	10 KOHM = R25 B=3977K t2		LE004100019	
15	Seal Burner door	Part of service kit-order LE000500001			
16	Insulation rope burner door	Part of service kit-order LE000500001			
17	Burner door thermostat	260° C (M5) Use with LE022000001		LE004200009	
18	Burner		LE004200010	LE004200010	LE004200011
20	Electrode	Part of service kit-order LE000500001			
21	Reducing coupling	G¼ x M5 Use with LE022000001		LE004500003	
22	Rear wall insulation	Part of service kit-order LE000500001			
23	Heat exchanger	Use with LE022000002	LE004500008	LE004500019	LE004500009
24	Burner door	Use with LE022000002		LE004500013	
25	Burner door insulation	Part of service kit-order LE000500001			
26	Sensor LWCO	Use with LE022000001		LE004500015	
27	Burner door thermostat	100° C Use with LE022000001		LE004500022	
28	Automatic air vent with clip connection			LE005500002	
29	Locking clip air vent			LE005500003	
30	Extension pipe air vent	Use with LE022000001		LE005500004	
33	Display unit			LE006500001	
41	Seat check valve	NRV		LE08500002	
42	Venturi VMS		LE008500004	LE008500008	LE008500009
43	Modulating gas valve	230VAC		LE008500012	
44	Burner Fan		LE008500014	LE008500015	LE008500016
45	Mounting plate silencer			LE008500019	
46	Wall mounting plate			LE009100001	
55	Condensate drain assembly	l=800		LE012200002	

## EFB SHORT REPLACEMENT PARTS LIST



Item No	Description of item	Item Comments	EFB85	EFB105	EFB125
<b>USE IN CONJUNCTION WITH DRAWING 1</b>					
56	Heat exchanger thermostat			LE013100002	
57	Gas-air mixing pipe			LE014500001	
59	Seal EPDM			LE016100011	
60	Clamp galvanised			LE016500008	
61	Set. Seal EPDM Adapter			LE016500010	
66	Ignition cable			LE031200001	
67	Harness HV/LV			LE031500001	
68	Adapter cable fan			LE031500002	
69	Gasket Burner & gas/air inlet pipe	Part of service kit-order LE000500001			
70	Gasket gas/air inlet pipe & fan			LE032200002	
71	Gasket condensate drain/bottom plate			LE032200003	
76	Gasket air vent hose/bottom plate			LE032500006	
81	Gasket electrode			LE032500011	
82	Gasket gas/air mixing			LE032500012	
84	Hose clamp	∅23,83 (DW15)		LE033500001	
85	Air pressure switch	DL 2 E with S-clip		LE033500002	
86	Quick-action clamp			LE033500003	
96	Hose air pressure switch			LE034500001	
97	Hose air vent			LE034500002	
98	Hose condensate trap			LE034500003	
99	Burner Control	Version B		LE160010014	
100	Measuring Cap	M20x2 Ral-9016		LE016500001	
n/a	Adhesive kit 04	Perma Clean, Permabond A905 and Permabond A131		LE022000001	
n/a	LOCTITE® SI 5366™	50ml		LE022000002	

# EFB SHORT REPLACEMENT PARTS LIST

## DRAWING 1

Any item not on list can be found on full spares list

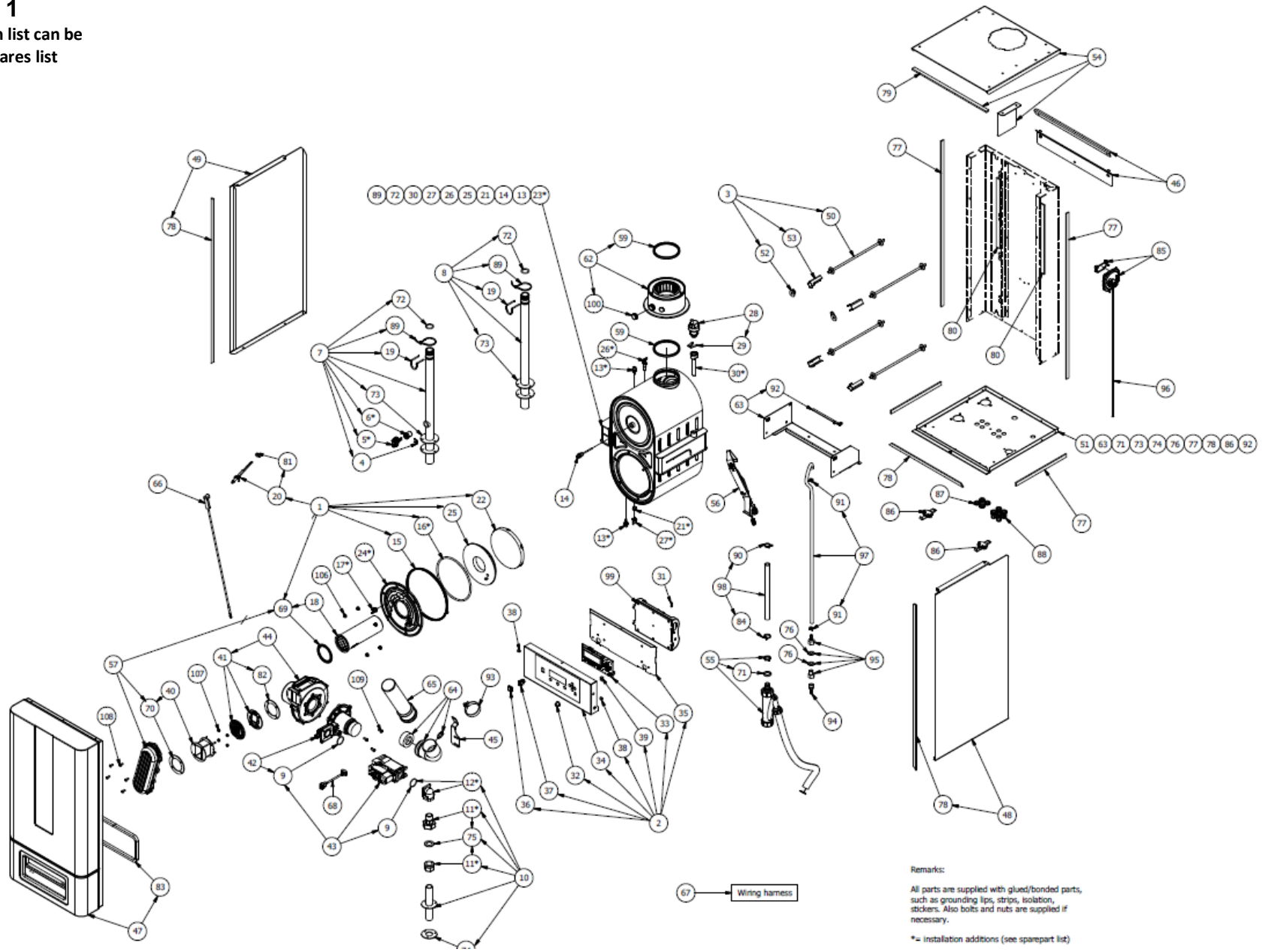

## EFB SHORT REPLACEMENT PARTS LIST



### EFB155 version B-any boiler manufactured after week 22-2020

Item No	Description of item	Item Comments	EFB155
<b>USE IN CONJUNCTION WITH DRAWING 2</b>			
1	Service kit		LE000500003
2	Set. Electronics holder		LE000500002
3	Set. Anchoring bar		LE000500010
5	Water pressure sensor 10bar		LE001500004
7	Flow pipe		LE001500008
8	Return pipe		LE002500005
9	O-ring gas valve connection		LE003100007
10	Gas pipe		LE003500004
13	NTC sensor 1/8" SS	Use with LE022000001	LE004100018
14	NTC Flue gas sensor	10 KOHM = R25 B=3977K t2	LE004100019
15	Seal Burner door	Part of service kit-order LE000500003	
16	Insulation rope burner door	Part of service kit-order LE000500003	
17	Burner door thermostat	260° C (M5) Use with LE022000001	LE004200009
18	Burner		LE004500020
20	Electrode	Part of service kit-order LE000500003	
21	Reducing coupling	G½ x M5 Use with LE022000001	LE004500003
22	Rear wall insulation	16mm	LE004500004
23	Heat exchanger	Use with LE022000002	LE004500018
24	Burner door	Use with LE022000002	LE004500013
25	Burner door insulation	Part of service kit-order LE000500003	
26	Sensor LWCO	Use with LE022000001	LE004500015
27	Burner door thermostat	100° C Use with LE022000001	LE004500022
28	Automatic air vent with clip connection		LE005500002
29	Locking clip air vent		LE005500003
30	Extension pipe air vent	Use with LE022000001	LE005500004
33	Display unit		LE006500001
41	Seat check valve	NRV	LE08500013
42	Venturi VMS		LE008500009
43	Modulating gas valve	230VAC	LE008500012
44	Burner Fan		LE008500017
45	Mounting plate silencer		LE008500019
46	Wall mounting plate		LE009100001
55	Condensate drain assembly	l=800	LE012200002

## EFB SHORT REPLACEMENT PARTS LIST



Item No	Description of item	Item Comments	EFB155
<b>USE IN CONJUNCTION WITH DRAWING 2</b>			
56	Heat exchanger thermostat		LE013100002
57	Gas-air mixing pipe		LE014500002
59	Seal EPDM		LE016500003
60	Clamp galvanised		LE016500009
61	Set. Seal EPDM Adapter		LE016500011
66	Ignition cable		LE031200001
67	Harness HV/LV		LE031500001
68	Adapter cable fan		LE031500002
69	Gasket Burner & gas/air inlet pipe	Part of service kit-order LE000500003	
71	Gasket condensate drain/bottom plate		LE032200003
76	Gasket air vent hose/bottom plate		LE032500006
81	Gasket electrode		LE032500011
82	Gasket gas/air mixing		LE032500012
84	Hose clamp	Ø23,83 (DW15)	LE033500001
85	Air pressure switch	DL 2 E with S-clip	LE033500002
86	Quick-action clamp		LE033500003
96	Hose air pressure switch		LE034500001
97	Hose air vent		LE034500002
98	Hose condensate trap		LE034500004
99	Burner Control	Version B	LE160010014
100	Measuring Cap	M20x2 Ral-9011	LE016500002
n/a	Adhesive kit 04	Perma Clean, Permabond A905 and Permabond A131	LE022000001
n/a	LOCTITE® SI 5366™	50ml	LE022000002

# EFB SHORT REPLACEMENT PARTS LIST

## DRAWING 2

Any item not on list can be found on full spares list

